

FIRST AMENDMENT TO CONSTRUCTION COST SHARING AGREEMENT

THIS FIRST AMENDMENT TO CONSTRUCTION COST SHARING AGREEMENT (the “First Amendment”) dated as of July 18, 2022 is made by and between the City of Minnetrista, whose address is 7701 Co Rd 110 W Minnetrista, MN 55364 (“City”), and Midcontinent Communications, a South Dakota partnership, whose address is 3901 North Louise Avenue, Sioux Falls, SD 57107 (“Midco”).

Recitals

WHEREAS, the parties executed a Construction Cost Sharing Agreement effective February 7, 2022 (“the Agreement”) regarding the expansion of high speed internet service and telephone service in the City; and

WHEREAS, the Parties now desire to expand the Project Area as defined in the Agreement.

NOW, THEREFORE, THE PARTIES AGREE TO AMEND THE AGREEMENT AS FOLLOWS:

1. Section 5 is amended to add the underlined language and to read as follows:

5. Commitment to Deliver Access to Service. Midco must make telephone and high speed internet service available as provided in paragraph 2 above to each of the residences named in Exhibit 3. Midco bears responsibility for all costs necessary to provide access to each of the residences named in Exhibit 3 in excess of the Cost Share Amount and the amount specified in section 14, and the City will incur no costs in excess of the Cost Share Amount and the amount specified in section 14 under this Agreement. Within sixty (60) days of execution of this Agreement, Midco shall provide the City with engineering design plans and diagrams for the project that demonstrate how high-speed internet and telephone service will reach each of the residences named in Exhibit 3, and demonstrate the timeline for the project’s completion.

2. Section 10 is amended to add the underlined language and to read as follows:

10. Assignment. Midco shall neither assign nor transfer any rights or obligations under this Agreement without the prior written consent of the City. In the event Midco proposes to assign or transfer the facilities constructed pursuant to this Agreement, the City shall have the right of first refusal concerning any offer to purchase which Midco intends to accept provided, however, that the City’s purchase price shall be reduced by the Cost Share Amount plus the amount specified in section 14, with interest calculated based on the annual reported consumer price index to the date of purchase. Any written purchase offer received by Midco shall be provided promptly to the City. In the event Midco terminates delivery of services over the facilities provided pursuant

to this Agreement, the City may purchase such facilities for Midco's actual construction cost, less reasonable depreciation and less the Cost Share Amount.

3. A new section 14 is added as follows:

14. In consideration of Midco's design, installation, and construction of an additional twenty (20) home passings, as illustrated on Exhibit 1 and Exhibit 3, the City shall pay an amount of \$52,000 to Midco within (60) days of Midco's completion of construction and submission of a detailed report of its actual construction costs and the City's inspection of the infrastructure. Such amount is in addition to any "Cost Share Amount" cap as outlined in section 4 Construction of the additional home passings shall be accomplished in accordance with the same terms and conditions as all other passings.

4. Exhibit 1 is deleted and a new Exhibit 1 as attached hereto is substituted in its place.
5. Exhibit 2 is deleted and a new Exhibit 2 as attached hereto is substituted in its place.
6. Exhibit 3 is deleted and a new Exhibit 3 as attached hereto is substituted in its place.
7. Except as explicitly provided for in this First Amendment, all terms and conditions of the Agreement continue to be in full force and effect.

[Signatures on Following Page]

CITY OF MINNETRISTA

By: 
Lisa Whalen, Mayor

By: 
Dawn Motzko, City Clerk

Midcontinent Communications d/b/a "Midco"

By: Midcontinent Communications Investor, LLC
Its Managing General Partner

By: 

Print name: Andrew Curley

Title: Director of Government Relations

EXHIBIT 1

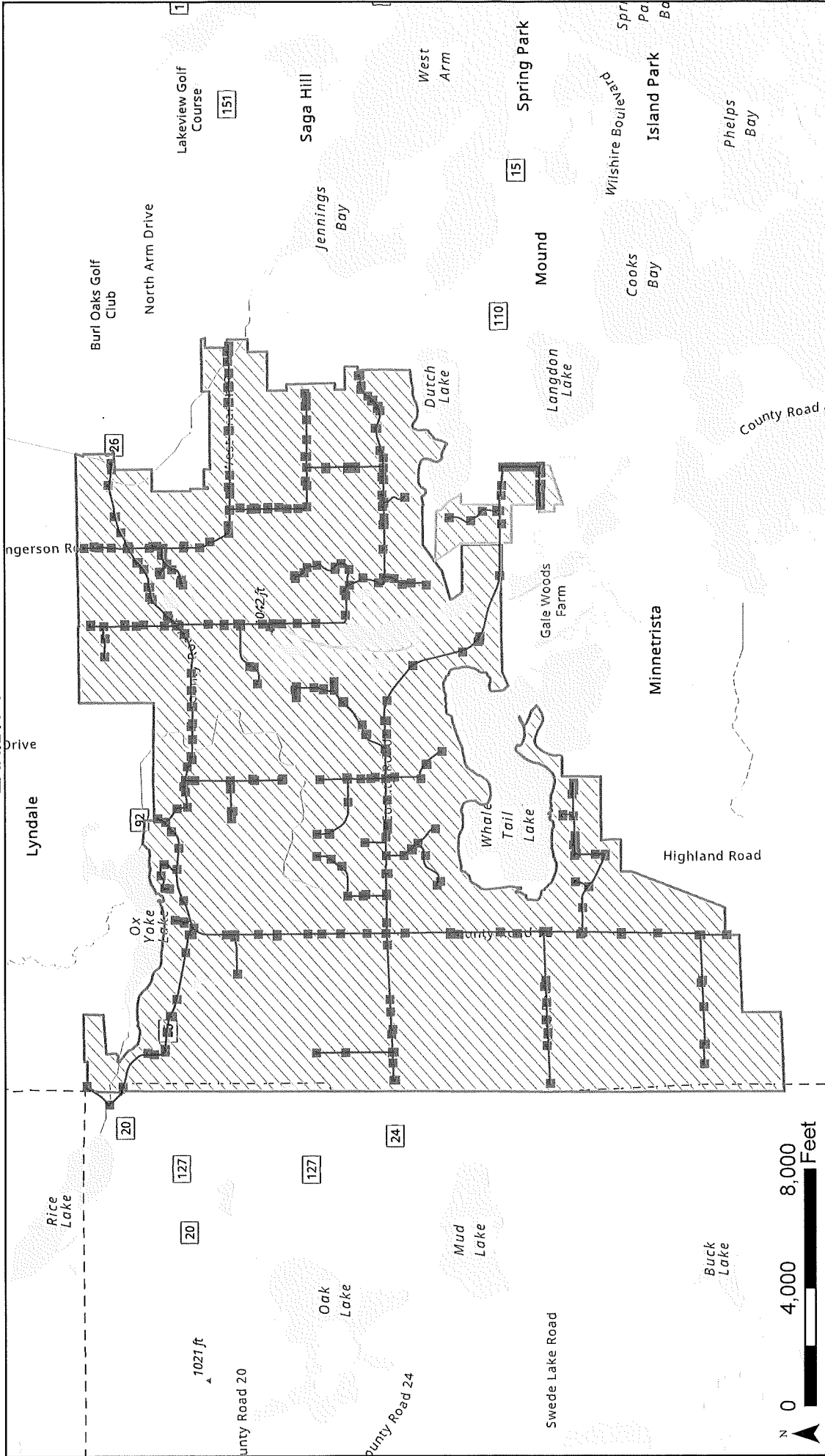

- Running Trench Line
- Pedestal Structure
- Additional Proposed Project Area
- Proposed Project Area

Minnetrista, MN

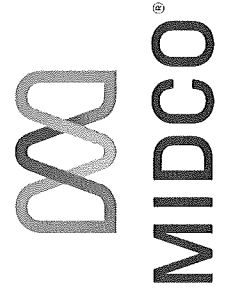

East: N.A.S.A., M.G.A., U.S.G.S. (F.E.D.A.), Metropolitan Council, Minneapolis, Minn.; River Park Estates, East, HERE, Comm. Sarcophagi, GeoTechnologies, Inc., MET, N.A.S.A., U.S.G.S., BPA, SPS, USDA

CONSTRUCTION COST SHARING AGREEMENT

EXHIBIT 2

CITY CONTROLLED RIGHT OF WAY

Ambjar Lane
Bertram Drive
Blair Road
Chateau Way
D'Chene Circle
D'Chene Lane
Deer Creek Road
Dutchview Road
Fielding Trail
Game Farm Road East
Game Farm Road North
Game Farm Circle
Hickory Drive
Highland Road Indian
Hill Road Ingerson
Road Kingswood Road
Kristin Lane
Lake Terrace Drive
Nike Road
North Branch Road
Prairie Meadow Road
Preserve Boulevard
Rainbow Road
Retreat Circle
Scott Drive
Squire Lane
Sterling Drive
Sunnyfield Road East
Sunnyfield Road North
Susan Lane
West Deer Creek Road
Westedge Boulevard
West Hill Road
West Highland Road
West Branch Road
Woodedge Road
Woodlawn Road

Exhibit 3

Street Address

2435 AMBJAR
2435 AMBJAR
2415 AMBJAR
2455 AMBJAR
2495 AMBJAR
2475 AMBJAR
1449 BERTRAM
1549 BERTRAM
1305 BLAIR
1405 BLAIR
1250 BLAIR
1350 BLAIR
1450 BLAIR
1505 BLAIR
781 BRANCH
5879 BRANCH
6055 BRANCH
6700 BRANCH
5975 BRANCH
575 BRANCH
500 BRANCH
5950 BRANCH
400 BRANCH
5900 BRANCH
6260 BRANCH
5869 BRANCH
500 BRANCH
6050 BRANCH
5949 BRANCH
5989 BRANCH
6255 BRANCH
6551 BRANCH
6725 BRANCH
5899 BRANCH
6501 BRANCH
6170 BRANCH
670 BRANCH
6000 BRANCH
705 BRANCH
355 BRANCH
6105 BRANCH
315 BRANCH
6600 BRANCH
5850 BRANCH
750 BRANCH
635 BRANCH

6305 BRANCH	
6205 BRANCH	
6175 BRANCH	
6500 BRANCH	
1755 CHATEAU	
1755 CHATEAU	
1750 CHATEAU	
1625 CHATEAU	
1700 CHATEAU	
1800 CHATEAU	
1675 CHATEAU	
1805 CHATEAU	
1725 CHATEAU	
1850 CHATEAU	
1616 CHATEAU	
9390 CORD	26
600 CORD	92
1071 CORD	92
9400 CORD	26
9200 CORD	26
20 CORD	20
1270 CORD	92
9201 CORD	26
9300 CORD	26
8420 CORD	15
9550 CORD	26
9500 CORD	15
8900 CORD	15
8460 CORD	15
9385 CORD	26
8310 CORD	15
9250 CORD	26
650 CORD	92
8280 CORD	15
9100 CORD	15
630 CORD	92
900 CORD	92
525 CORD	92
8050 CORD	26
40 CORD	20
1350 CORD	92
9060 CORD	26
8075 CORD	26
700 CORD	92
9250 CORD	15
8201 CORD	26
8850 CORD	26

1460 CORD	92
9455 CORD	26
500 CORD	92
585 CORD	92
8900 CORD	26
9300 CORD	15
7950 CORD	26
9190 CORD	15
1310 CORD	92
540 CORD	92
8150 CORD	15
8780 CORD	15
2501 CORD	92
1750 CORD	92
8301 CORD	15
2400 CORD	92
2755 CORD	92
8501 CORD	15
2300 CORD	92
9455 CORD	15
8241 CORD	15
9401 CORD	15
8101 CORD	15
2970 CORD	92
1835 CORD	92
3305 CORD	92
2201 CORD	92
1815 CORD	92
3205 CORD	92
9301 CORD	15
2855 CORD	92
1820 CORD	92
8271 CORD	15
7755 CORD	15
7805 CORD	15
7240 CORD	15
7255 CORD	15
7925 CORD	15
7895 CORD	15
7885 CORD	15
7373 CORD	15
7480 CORD	15
7205 CORD	15
7655 CORD	15
7321 CORD	15
7000 CORD	15
6868 CORD	15

7425 CORD	15
7341 CORD	15
7610 CORD	15
7700 CORD	26
7055 CORD	26
6925 CORD	26
7855 CORD	26
6625 CORD	26
7500 CORD	26
6445 CORD	26
7850 CORD	26
6795 CORD	26
7180 CORD	26
6480 CORD	26
7940 CORD	26
7790 CORD	26
7970 CORD	26
7805 CORD	26
7760 CORD	26
7880 CORD	26
7155 CORD	26
7730 CORD	26
7050 CORD	26
6530 CORD	26
7020 CORD	26
7885 CORD	26
6980 CORD	26
7901 CORD	26
6800 CORD	26
6820 CORD	26
7255 CORD	26
6975 CORD	26
6555 CORD	26
7910 CORD	26
6875 CORD	26
6200 CORD	26
7300 CORD	26
6600 CO RD 15	
6801 CO RD 15	
6575 CO RD 15	
545 DCHENE	
6845 DCHENE	
6840 DCHENE	
6965 DCHENE	
7000 DCHENE	
440 DCHENE	
6920 DCHENE	

6885 DCHENE
6960 DCHENE
6925 DCHENE
1245 DEERCREEK
1525 DEERCREEK
1305 DEERCREEK
617 DEERCREEK
1385 DEERCREEK
1535 DEERCREEK
8150 DEERCREEK
1045 DEERCREEK
1105 DEERCREEK
8008 DEERCREEK
8245 DEERCREEK
8118 DEERCREEK
1545 DEERCREEK
1855 DEERCREEK
7850 DEERCREEK
7950 DEERCREEK
7955 DEERCREEK
7805 DEERCREEK
1750 DEERCREEK
1560 DEERCREEK
1050 DEERCREEK
1300 DEERCREEK
1090 DEERCREEK
1180 DEERCREEK
1000 DEERCREEK
980 DEERCREEK
920 DEERCREEK
2005 DUTCHVIEW RD
2000 DUTCHVIEW RD
2105 DUTCHVIEW RD
2500 DUTCHVIEW RD
2561 DUTCHVIEW RD
7405 FIELDING
7450 FIELDING
7500 FIELDING
7455 FIELDING
7505 FIELDING
6085 GAME FARM
5985 GAME FARM
6427 GAME FARM
6525 GAME FARM
5925 GAME FARM
6625 GAME FARM
6485 GAME FARM

6055 GAME FARM
6089 GAME FARM
6695 GAME FARM
6075 GAME FARM
6365 GAME FARM
6010 GAME FARM
5970 GAME FARM
1475 GAME FARM
1350 GAME FARM
1510 GAME FARM
1150 GAME FARM
6700 GAME FARM
6250 GAME FARM
1355 GAME FARM
6420 GAME FARM
1194 GAME FARM
6470 GAME FARM
1205 GAME FARM
1475 GAME FARM
1100 GAME FARM
5910 GAME FARM
6690 GAME FARM
1640 GAME FARM
1600 GAME FARM
6640 GAME FARM
6800 GAME FARM
6670 GAME FARM
6520 GAME FARM
1460 GAME FARM
6610 GAME FARM
1410 GAME FARM
1190 GAME FARM
1450 GAME FARM
1250 GAME FARM
1400 GAME FARM
1625 GAME FARM
1192 GAME FARM
1200 GAME FARM
1310 GAME FARM
1480 GAME FARM
1500 GAME FARM
6450 GAME FARM
6570 GAME FARM
1176 GAME FARM
6060 GAME FARM
6080 GAME FARM
1300 GAME FARM

1105 GAME FARM
6170 GAME FARM
6905 GAME FARM
305 GAME FARM
730 GAME FARM
320 GAME FARM
100 GAME FARM
350 GAME FARM
725 GAME FARM
825 GAME FARM
375 GAME FARM
205 GAME FARM
680 GAME FARM
780 GAME FARM
955 GAME FARM
15 GAME FARM
1020 GAME FARM
455 GAME FARM
630 GAME FARM
900 GAME FARM
380 GAME FARM
115 GAME FARM
215 GAME FARM
6087 GAME FARM
1570 HICKORY
1425 HICKORY
1455 HICKORY
1375 HICKORY
1400 HICKORY
1550 HICKORY
1300 HICKORY
2485 HIGHLAND
2545 HIGHLAND
2485 HIGHLAND
2545 HIGHLAND
2650 HIGHLAND
2770 HIGHLAND
2500 HIGHLAND
8500 HIGHLAND
2605 HIGHLAND
2565 HIGHLAND
2785 HIGHLAND
2585 HIGHLAND
2560 HIGHLAND
2555 HIGHLAND
2350 HIGHLAND
9300 HILL

9300 HILL
9550 HILL
9101 HILL
9450 HILL
9255 HILL
9100 HILL
9255 INDIANHILL
8805 INDIANHILL
201 INGERSON
255 INGERSON
155 INGERSON
200 INGERSON
7805 KINGSWOOD
7651 KINGSWOOD
7800 KINGSWOOD
7485 KINGSWOOD
7701 KINGSWOOD
7850 KINGSWOOD
7700 KINGSWOOD
7575 KINGSWOOD
7600 KINGSWOOD
7210 KINGSWOOD
530 KRISTIN
565 KRISTIN
535 KRISTIN
505 KRISTIN
560 KRISTIN
530 LAKE TERRACE
505 LAKE TERRACE
440 LAKE TERRACE
445 LAKE TERRACE
475 LAKE TERRACE
500 LAKE TERRACE
560 LAKE TERRACE
470 LAKE TERRACE
410 LAKE TERRACE
9555 NIKE
9333 NIKE
9300 NIKE
9255 NIKE
9200 NIKE
9300 NIKE
9199 NIKE
9300 NIKE
9400 NIKE
1373 PRAIRIE MEADOW
1195 PRAIRIE MEADOW

1300 PRAIRIE MEADOW
1360 PRESERVE
1410 PRESERVE
1295 PRESERVE
1240 PRESERVE
1375 PRESERVE
1370 RAINBOW
1200 RAINBOW
1205 RAINBOW
1770 RETREAT
1775 RETREAT
1701 RETREAT
1800 RETREAT
1670 RETREAT
1705 RETREAT
1720 RETREAT
1620 RETREAT
1205 SCOTT
1260 SCOTT
1265 SCOTT
1235 SCOTT
1230 SCOTT
1180 SCOTT
8425 SQUIRE
8490 SQUIRE
8580 SQUIRE
8485 SQUIRE
8565 SQUIRE
1685 STERLING
1715 STERLING
1690 STERLING
6085 SUNNYFIELD
1205 SUNNYFIELD
6475 SUNNYFIELD
6065 SUNNYFIELD
1105 SUNNYFIELD
6385 SUNNYFIELD
6145 SUNNYFIELD
6525 SUNNYFIELD
6175 SUNNYFIELD
6001 SUNNYFIELD
6225 SUNNYFIELD
6051 SUNNYFIELD
1195 SUNNYFIELD
6115 SUNNYFIELD
1155 SUNNYFIELD
6605 SUNNYFIELD

1110 SUNNYFIELD
6350 SUNNYFIELD
6400 SUNNYFIELD
6300 SUNNYFIELD
6250 SUNNYFIELD
985 SUNNYFIELD
6070 SUNNYFIELD
6310 SUNNYFIELD
1150 SUNNYFIELD
890 SUNNYFIELD
1090 SUNNYFIELD
1025 SUNNYFIELD
5990 SUNNYFIELD
1005 SUNNYFIELD
820 SUNNYFIELD
1015 SUNNYFIELD
875 SUNNYFIELD
1000 SUNNYFIELD
7560 SUSAN
7530 SUSAN
7575 SUSAN
7500 SUSAN
7590 SUSANLA
2355 WESTEDGE BLVD
2400 WESTEDGE BLVD
6700 WOODEDGE RD
6600 WOODEDGE RD
6550 WOODEDGE RD
6650 WOODEDGE RD
6555 WOODEDGE RD
6605 WOODEDGE RD
6655 WOODEDGE RD
6705 WOODEDGE RD
6755 WOODEDGE RD
6805 WOODEDGE RD
6600 WOODLAWN